

cCSAus Transformers

C- Range Data Sheet

cCSAus approved Transformers

Technical data _____

Control Transformer	Class 1 Isolation Transformer with Earth Screen between Primary and Secondary			
Standard	C22.2 No. 0-M91, C22.2 No. 0.4.04, C22.2 No. 66.1-06 UL5085-1, C22.2 N0. 66.2-06, UL5085-2			
Primary Voltages	100 - 600V			
Secondary Voltages	12 - 600V			
Frequency	50/60Hz			
Insulation Class	B			
VA Ratings	25VA to 5kVA			
Dielectric Strength test. Winding to winding and winding to core	<u>250VA or Less</u>		<u>250VA to 5000VA</u>	
	For 25V Winding	1050V	250V or less	2500V
	26V – 250V	1500V	251 – 600V	4000V
	251 – 600V	2500V		
Ambient Temperature	25°C			
MTBF	200,000hrs			

25VA – 2500VA

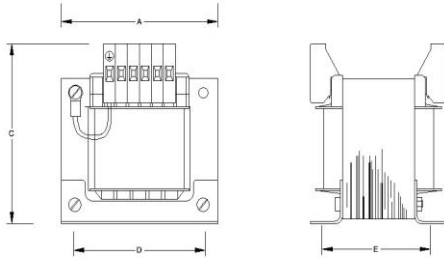

VA	A	B	C	D	E	Weight Kg
25	66	68	77	50	44	0.7
50	75	70	86	56	47	1.1
63	75	76	86	56	53	1.5
100	84	78	95	64	63	2.1
150	96	86	102	84	72	2.8
200	96	101	102	84	90	3.7
250	120	88	122	90	73	4.4
300	120	100	122	90	85	5.3
400	120	120	122	90	106	6.5
500	150	135	140	122	82	7.5
750	150	161	140	122	106	10
1000	150	188	140	122	134	14
1500	192	172	180	160	125	20.5
2000	192	172	180	160	125	20.5
2500	192	178	180	160	153	24
3000	200	130	300	160	110	20
4000	200	150	300	160	120	30
5000	240	150	390	200	110	40

3000VA – 5000VA

